

APPENDIX 'C'



Licensing Section, Priory House, Monks Walk, Chicksands, Shefford, Beds SG17 5TQ
 Telephone: 08452 304040 Fax: 08702 432151 DX 153440 Shefford

PREMISES LICENCE

Premises licence number	2000088
--------------------------------	---------

Part 1 – Premises details

Postal address of premises, or if none, ordnance survey map reference or description			
Camp Stores 20 Bedford Road			
Town	Lower Stondon	Post code	SG16 6EA
Telephone number	01462 813667		

Where the licence is time limited the dates
--

Licensable activities authorised by the licence
Supply of alcohol

The times the licence authorises the carrying out of licensable activities

Supply of Alcohol Standard days and timings			<u>The supply of alcohol for consumption as indicated by area ticked</u>	On the Premises	
				Off the Premises	√
Day	Start	Finish	Both		
Mon	08:00	23:00	<u>Non-standard timings. Where you intend to use the premises for the supply of alcohol at different times to those listed in the column on the left</u> Good Friday 08:00 to 22:30 Christmas Day 12:00 to 15:00 then 19:00 to 22:30		
Tue	08:00	23:00			
Wed	08:00	23:00			
Thur	08:00	23:00			
Fri	08:00	23:00			
Sat	08:00	23:00			
Sun	10:00	22:30			

The opening hours of the premises

Hours Premises are Open to the Public Standard days and timings			
Day	Start	Finish	
Mon			<u>Non-standard timings. Where you intend the premises to be open to the public at different times from those listed in the column on the left,</u> No Restrictions.
Tue			
Wed			
Thur			
Fri			
Sat			
Sun			

Where the licence authorises supplies of alcohol whether these are on and/or off supplies

OFF

Part 2

Name, (registered) address, telephone number and e-mail (where relevant) of holder of premises licence

Dhimantkumar Somabhai Patel
735 Dunstable Road
Luton
LU4 0DU

01582 573511

Registered number of holder, for example company number, charity number (where applicable)

N/A

Name, address and telephone number of designated premises supervisor where the premises licence authorises the supply of alcohol

Dhimantkumar Somabhai Patel
735 Dunstable Road
Luton
LU4 0DU

01582 573511

Personal licence number and issuing authority of personal licence held by designated premises supervisor where the premises licence authorises the supply of alcohol

051688 - Luton Borough Council

Annex 1 - Mandatory conditions

Mandatory conditions where licence authorises supply of alcohol

- 1) No supply of alcohol may be made under the premises licence-
 - (a) at a time when there is no designated premises supervisor in respect of the premises licence, or
 - b) at a time when the designated premises supervisor does not hold a personal licence or his personal licence is suspended.

- 2) Every supply of alcohol under the premises licence must be made or authorised by a person who holds a personal licence.

**Conversion of Existing Licenses
Schedule 8 paragraph 6 of the Licensing Act 2003**

This Licence has been granted upon conversion under Schedule 8 of the Licensing Act 2003 of the existing Justices Licence and such rights and restrictions that applied thereto are hereby incorporated into this Licence, subject to any terms herein to the contrary and/or any limitations or restrictions imposed by the Licensing Act 2003 or any subsequent amendment thereto.

Off Licences			
s. 60, 63, 86, Licensing Act 1964	Permitted hours (Off-licences and off-sales departments of on-licensed premises)	ER	<p>“Alcohol shall not be sold or supplied except during permitted hours.</p> <p>In this condition, permitted hours means:</p> <ol style="list-style-type: none"> a. On weekdays, other than Christmas Day, 8 a.m. to 11 p.m. b. On Sundays, other than Christmas Day, 10 a.m. to 10.30 p.m. c. On Christmas Day, 12 noon to 3 p.m. and 7p.m. to 10.30 p.m. d. On Good Friday, 8 a.m. to 10.30 p.m. <p>The above restrictions do not prohibit:</p> <ol style="list-style-type: none"> (a) the taking of the alcohol from the premises, (unless the alcohol is supplied or taken in an open vessel,) during the first twenty minutes after the above hours; (b) the ordering of alcohol to be consumed off the premises, or the despatch by the vendor of the alcohol so ordered; (c) the sale of alcohol to a trader or club for the purposes of the trade or club; (d) the sale or supply of alcohol to any canteen or mess, being a canteen in which the sale or supply of alcohol is carried out under the authority of the Secretary of State or an authorised mess of members of Her Majesty’s naval, military or air forces.”

Off Licences			
S.164 Licensing Act 1964	Off-licence Consumption	ER	"Alcohol shall not be sold in an open container or be consumed in, the licensed premises."

Annex 2 - Conditions consistent with the Operating Schedule

- 1) CCTV fitted to Crime Prevention officers requirements.
- 2) Nationally recognised proof of age cards and other photographic ID cards to be requested as verification of proof of age.

Annex 3 – Conditions attached after a hearing with the licensing authority.

None.

--	--	--	--

Annex 4 - Plans

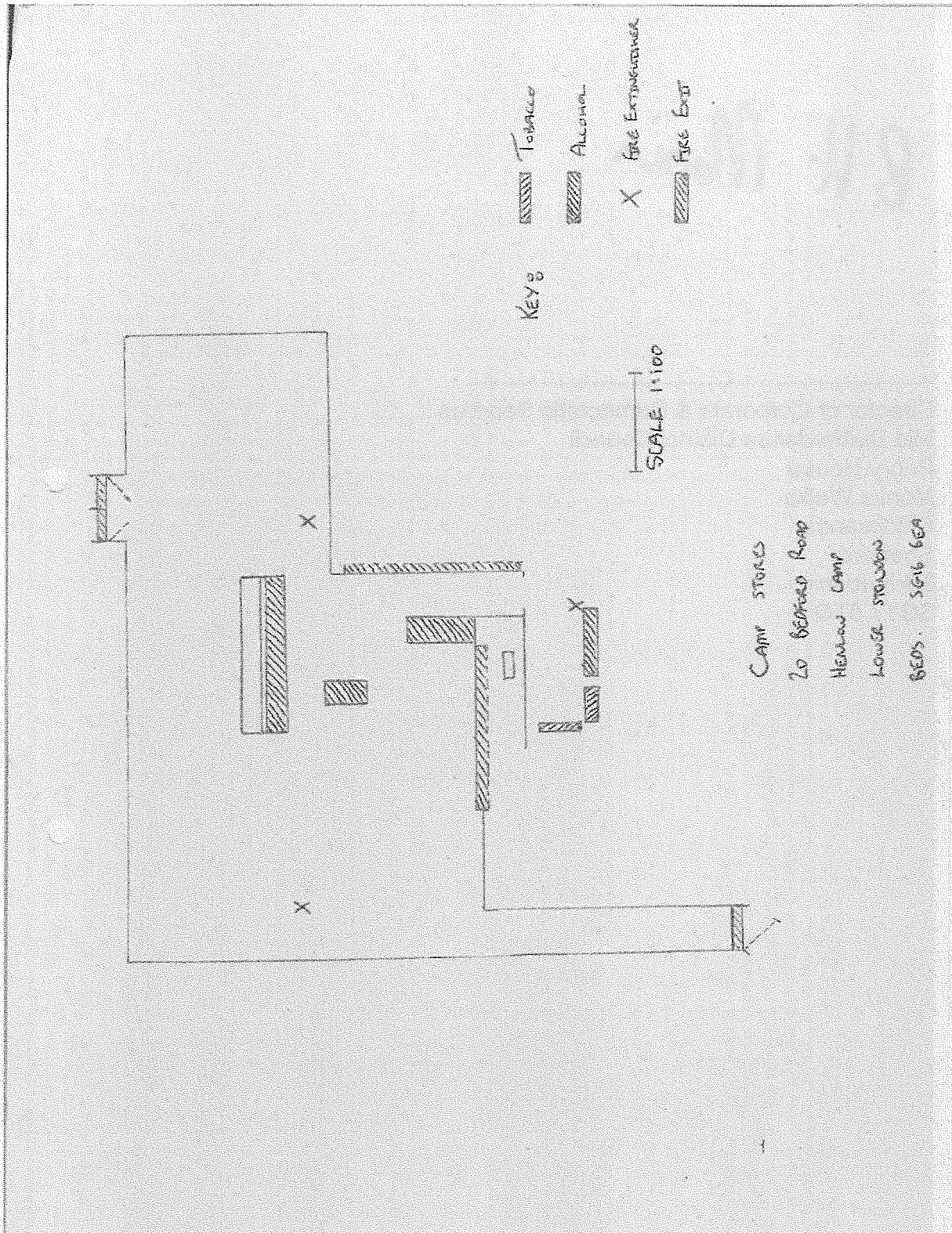

This licence was granted on 24th November 2005

B. U. Morris

Director of Corporate & Democratic Services
Mid Bedfordshire District Council
Priory House
Monks Walks
Chicksands
Shefford
Bedfordshire
SG17 5TQ



Licensing Section, Priory House, Monks Walk, Chicksands, Shefford, Beds SG17 5TQ
 Telephone: 08452 304040 Fax: 08702 432151 DX 153440 Shefford

Part B
Premises licence summary

Premises licence number	2000088
--------------------------------	---------

Premises details

Postal address of premises, or if none, ordnance survey map reference or description Camp Stores 20 Bedford Road	
Town Lower Stondon	Post code SG16 6EA
Telephone number 01462 813667	

Where the licence is time limited the dates
--

Licensable Activities authorised by the licence Supply of Alcohol

The times the licence authorises the carrying out of licensable activities

Supply of Alcohol Standard days and timings			The supply of alcohol for consumption as indicated by area ticked	On the Premises	
				Off the Premises	√
Day	Start	Finish		Both	
Mon	08:00	23:00	<u>Non-standard timings. Where you intend to use the premises for the supply of alcohol at different times to those listed in the column on the left</u> Good Friday 08:00 to 22:30 Christmas Day 12:00 to 15:00 then 19:00 to 22:30		
Tue	08:00	23:00			
Wed	08:00	23:00			
Thur	08:00	23:00			
Fri	08:00	23:00			
Sat	08:00	23:00			
Sun	10:00	22:30			

The opening hours of the premises

Hours Premises are Open to the Public Standard days and timings		
Day	Start	Finish
Mon		
Tue		
Wed		
Thur		
Fri		
Sat		
Sun		

Non-standard timings. Where you intend the premises to be open to the public at different times from those listed in the column on the left,

No Restrictions.

Where the licence authorises supplies of alcohol whether these are on and/or off supplies

OFF

Name, (registered) address of holder of premises licence

Dhimantkumar Somabhai Patel
735 Dunstable Road
Luton
LU4 0DU

Registered number of holder, for example company number, charity number (where applicable)

N/A

Name of designated premises supervisor where the premises licence authorises the supply of alcohol

Dhimantkumar Somabhai Patel

State whether access to the premises by children is restricted or prohibited

Not applicable